

KWC

ARMATUREN
ROBINETTERIE
RUBINETTERIA
GRIFERIA
FAUCETS

802 136

04/03

Installation and service instructions
Instructions de montage et d'entretien
Instrucciones de montaje y servicio

Bar faucets
Robinetterie de bar
Grifería para barras

KWC DOMO
KWC TOPLINE
KWC STAR
KWC DORADO

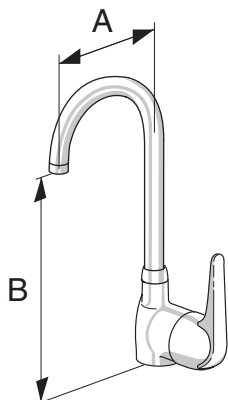

KWC DOMO
K.10.61.U1 A=116mm / 4 1/2"
B=295mm / 11 5/8"

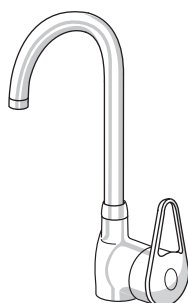

KWC TOPLINE
K.10.B1.U1 A=116mm / 4 1/2"
B=295mm / 11 5/8"

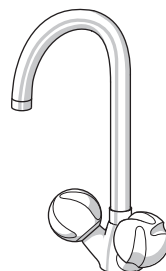

KWC STAR
K.10.41.81 A=116mm / 4 1/2"
B=240mm / 9 7/16"

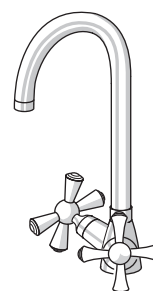

KWC DORADO
K.10.X1.81 A=116mm / 4 1/2"
B=240mm / 9 7/16"

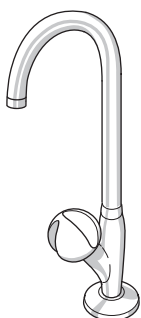

KWC STAR
K.25.40.81 A=116mm / 4 1/2"
B=275mm / 10 13/16"

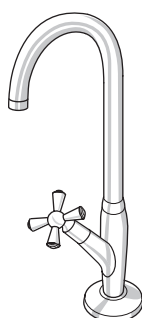

KWC DORADO
25.X0.81 A=116mm / 4 1/2"
B=275mm / 10 13/16"

E Operating data

Ideal operating pressure : 3 bar (45 PSI)
Max. operating pressure : 5 bar (70 PSI)
Max. pressure difference cold/hot : 2 bar (25 PSI)
Equal pressures are recommended.
Ideal water temperature : 60 °C (140°F)
Max. water temperature : 90 °C (194°F)

Attention:

Before installation flush pipes thoroughly!

F Caractéristiques de fonctionnement

Pression de service idéale : 3 bar (45 PSI)
Pression de service max. : 5 bar (70 PSI)
Différence de pression E./F./E.C. max. : 2 bar (25 PSI)
Egalité de pression recommandée.
Température idéale de l'eau : 60 °C (140°F)
Température max. de l'eau : 90 °C (194°F)

Attention:

Rincer à fond la tuyauterie avant le montage!

SP Datos de servicio

Presión ideal de servicio : 3 bar (45 PSI)
Presión máxima de servicio : 5 bar (70 PSI)
Diferencia máxima de presión fría / caliente : 2 bar (25 PSI)
Se recomienda la igualdad de las presiones.
Temperatura ideal del agua : 60 °C (140°F)
Temperatura máxima del agua : 90 °C (194°F)

Atención:

Enjuagar escrupulosamente las tuberías antes del montaje!

KWC

ARMATUREN
ROBINETTERIE
RUBINETTERIA
GRIFERIA
FAUCETS

KWC FAUCETS INC.
1770 Corporate Drive # 580
NORCROSS, GA 30093

Phone: 678 - 334 - 2121
Fax: 678 - 334 - 2128

NORTESCO INC.
151 Carlingview Drive, Unit 12
Rexdale, Ontario M9W 5S4
Toronto

Phone: 416 - 675 - 3434
Main-Toll Free 1-800 - NOR TESCO
Fax: 416 - 675 - 0167

NORTESCO INC.
61 Lindsay Avenue
Dorval, Que. H9P 2S6
Montreal

Phone: 514 - 636 - 6116
Fax: 514 - 636 - 5491

Installation / Taking into service

1

Montage / Mise en Service

Montaje / Puesta en servicio

Limitation of flow rate (mixer only)

2

Limitation du débit (mitigeur seulement)

Limitación del caudal (solamente mezclador)

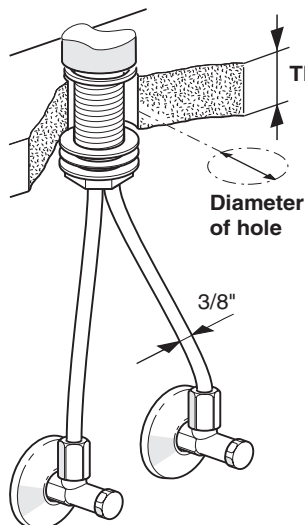

	Diameter of hole	Thickness
	ø 35mm ø 1 3/8"	max 60mm max 2 3/8"
	ø 28mm ø 3/4"	max 31mm max 1 1/4"
	ø 22mm ø 1/2"	max 75mm max 3"

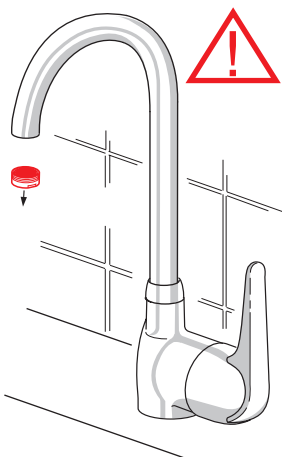

- E** Flush faucet (first remove Neoperl aerator)
- F** Rincer le robinet (démonter d'abord le Neoperl aérateur)
- SP** Enjuague el grifo (primero desmonte el Neoperl)

KWC DOMO

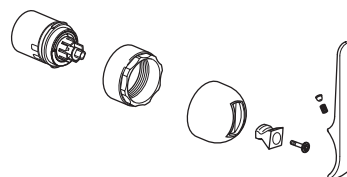
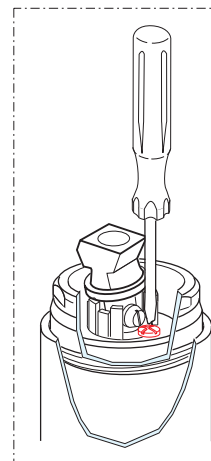
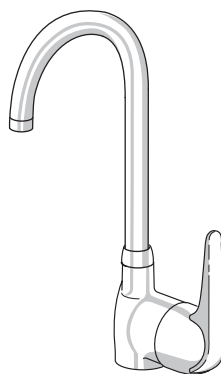

KWC TOPLINE

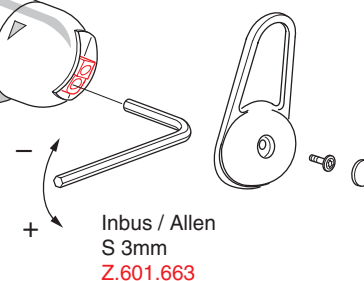
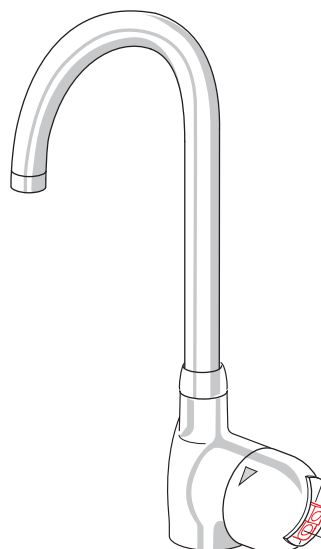

**Escutcheon
Rosace
Roseta**

Z.504.806 length: 262mm / 10"
Z.504.807 length: 160mm / 6"

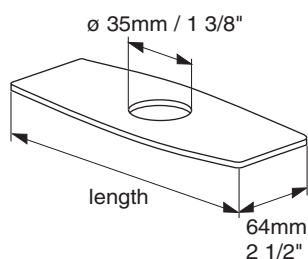

**Faucet hole cover
Couvercle pour trou de rob.
Placa de cubierta**

Z.504.093

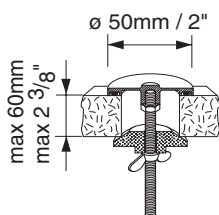

Temperature Limitation
Limitation de la température max.
Limitación de la temperatura máxima

3

Replacing the control cartridge
Remplacement de la cartouche
Recambio del cartucho de mando

4

mixer only
mitigeur seulement
solamente mezclador

KWC DOMO

Limitator ring (yellow)
 L'anneau de limitation (jaune)
 Anillo de limitación (amarillo)

Inbus / No 3

KWC TOPLINE

Torx 20 / No 4

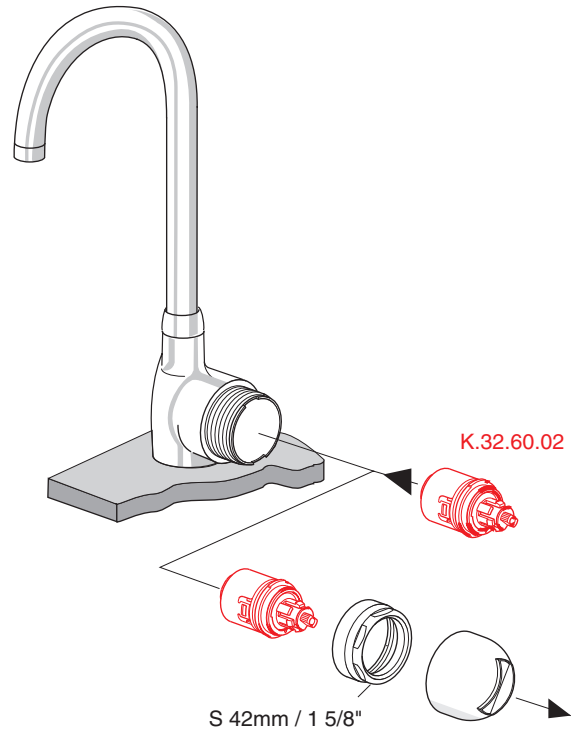

Max. temperature range
Plage de température max.
Gama de temperaturas máx.

Reduced temperature range
Plage de température réduite
Gama de temperaturas reducidas

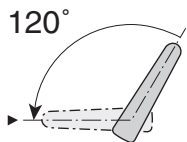
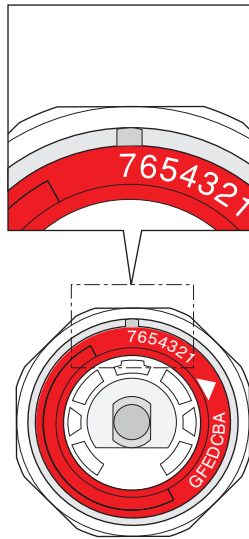
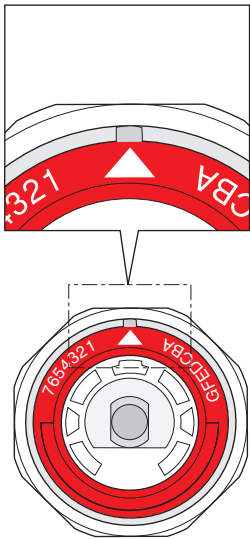

Arrow on groove
 Flèche sur encroche
 Flecha en la hendidura

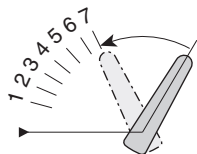

Positions 1 - 7
 Position 1 - 7
 Posición 1 - 7

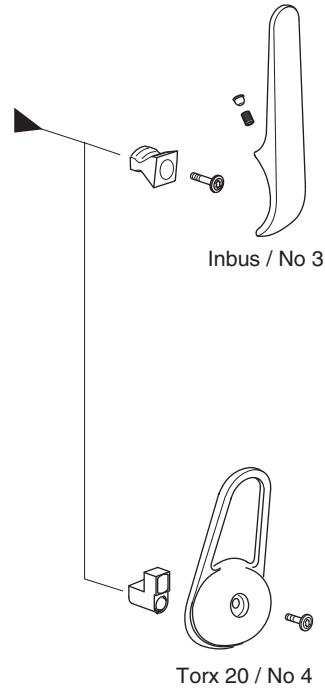

KWC DOMO

KWC TOPLINE

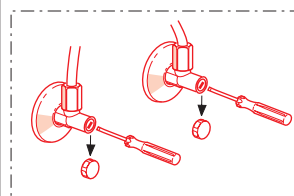

Turn off cold and hot water
 Fermer eau froide et chaude
 Interrumpir la salida de agua fría y caliente

Spare parts
Pièces de rechange
Repuestos

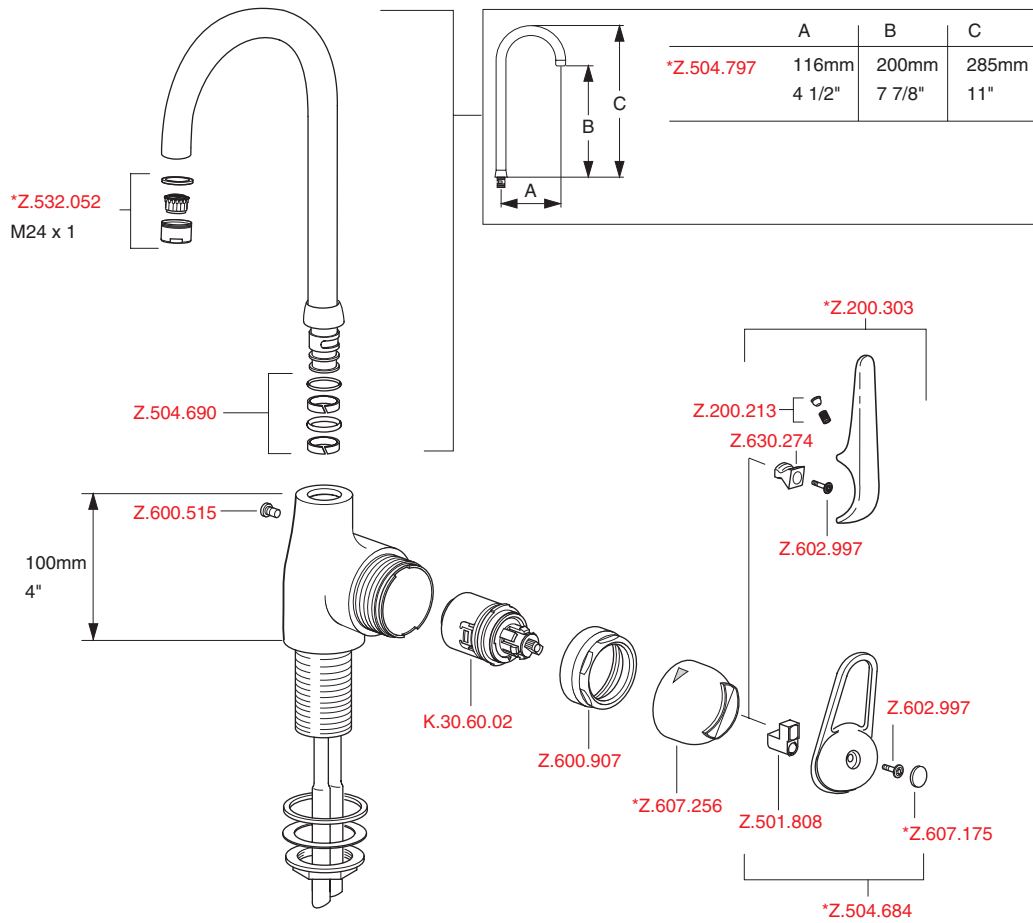

KWC DOMO

KWC TOPLINE

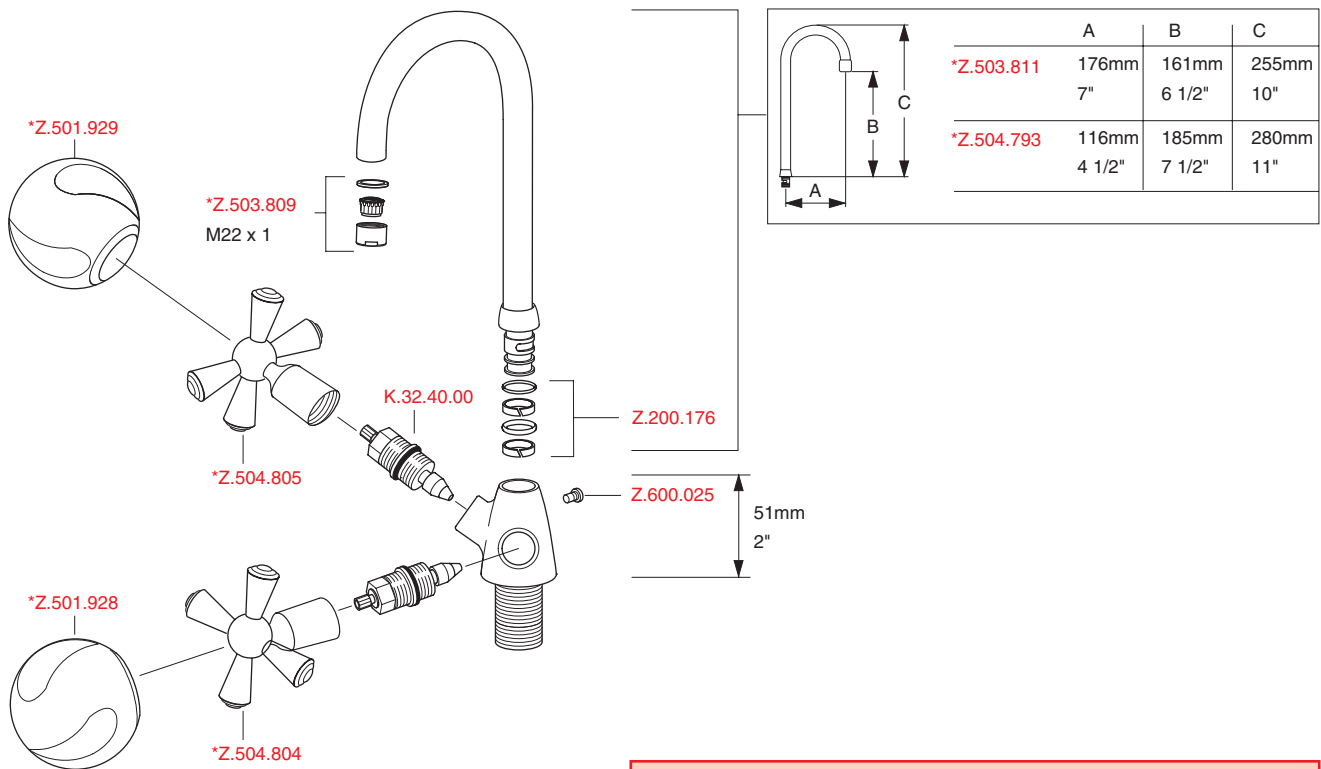

KWC STAR

KWC DORADO

E * Please specify the color when placing your order.
F * Lors de la commande, veuillez indiquer la couleur, s.v.p.
Sp * Rogamos indicar el color al hacer el pedido.